



DD2000 JACK GEARBOX



WARNING: READ INSTRUCTIONS CAREFULLY BEFORE ATTEMPTING TO INSTALL, OPERATE, OR SERVICE THIS PRODUCT. FAILURE TO COMPLY WITH INSTRUCTIONS COULD RESULT IN SERIOUS INJURY. RETAIN THESE INSTRUCTIONS FOR FUTURE REFERENCE.



IMPORTANT SAFETY INFORMATION

- Respect this gearbox. High forces are created during operation, creating potential safety hazards. It should be operated and maintained in accordance with instructions. Never allow children or anyone who is not familiar with the operation of the gearbox to use it. A gearbox accident could result in personal injury.
- Check gearbox and jack for proper operation on each use. Do not use if damaged or if connection is insecure. Seek immediate repairs.
- Never exceed rated capacity. Excess load may cause premature failure and could result in serious personal injury.
- If using an electric drill, first remove handle from shafts. Attach drill only to the triangular portion of the clutch shaft, not the primary shaft. To minimize heat buildup and possible damage, do not exceed 600 rpm. Do not use an impact driver to operate this product. Hold the electric drill with two hands when operating to minimize possibility of injury.

INSTALLATION

With the weight off of the jack, use a T25 Torx bit to remove the cap from the outer post. Use a 5/32" pin punch and hammer to remove the roll pin from the handle of the jack. Assemble the gearbox in place of the handle using the replacement roll pin and existing jack gear components. Mount the appropriate bracket around the jack tube to the box using a 3/16 hex key. Grease the jack miter gears and reattach jack cap.

MAINTENANCE

Minimal maintenance is required to keep the gear box in good working order. Lubrication is needed if cranking feels rough or produces a grinding noise. With the weight off of the jack, use a 3/16 hex key to carefully remove the front cover from the gearbox. Wipe away old grease from gears. Lubricate the gear teeth, avoiding clutch pads on either side of the clutch shaft. Lubricate the bearings and reassemble.

OPERATION

This gearbox is designed to lift load (extend) when either drive shaft is cranked in a clockwise direction. Load will lock in position when cranking stops. To lower load (retract), turn either drive shaft counterclockwise. For operation by handle, depress the handle clip and slide it over either shaft. Release the clip, locking the handle into the groove on the shaft. Attach to the primary shaft for faster operation at increased torque. For operation by electric drill, remove the handle from both shafts before operation. Failure to do so may result in injury. Handle mount storage is available on the side of the gearbox. Attach the drill chuck to the triangular portion of the clutch shaft, tightening the drill teeth fully against the shaft's flat surfaces. Hold the drill firmly with both hands while operating. The clutch shaft is equipped with a slip clutch designed to disengage the load when over-torqued. A slight jolt may occur when the jack fully extends or retracts. If the jack stops lifting or lowering the load while the clutch shaft is still turning, the slip clutch is engaged. **STOP CRANKING.** Excessive engagement of the slip clutch may cause premature clutch failure. Clutch failure will maintain load position but may cause a sudden jolt at the shaft. Clutch failure may disable the clutch shaft's ability to carry load. If this occurs, seek repairs and only operate the primary shaft by handle.



A Dependable Company Since 1886
DUTTON-LAINSON COMPANY
Hastings, NE 68902 U.S.A · Tel 402-462-4141 · Fax 402-460-4612
www.dutton-lainson.com · E-mail: dlsales@dutton-lainson.com



PATENT PENDING

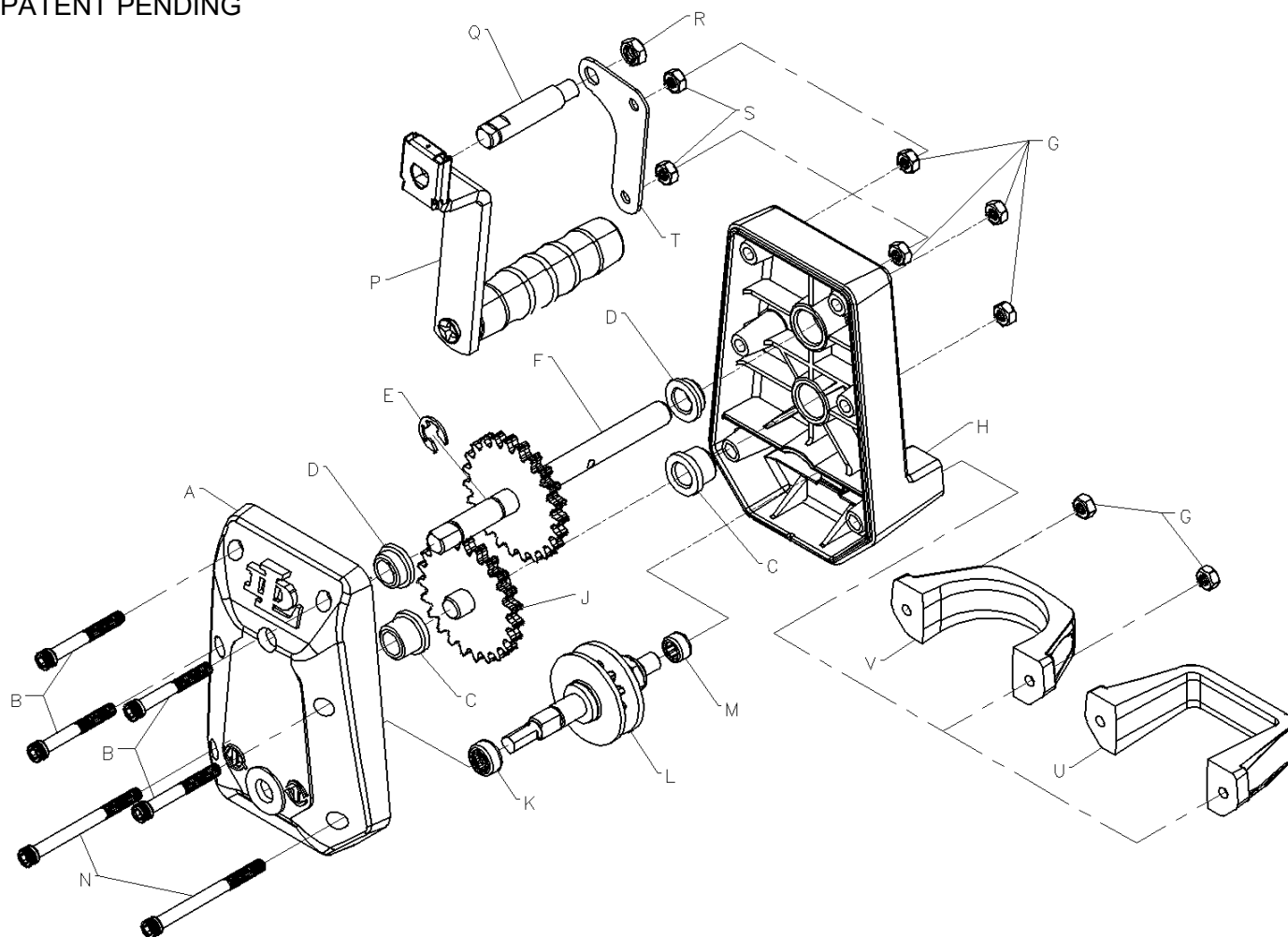

DD2000

Ref.	Description	Part no.	Ref.	Description	Part no.
A	Front Cover	207662	L	Clutch Shaft Assembly	303940
B	2" Screw (4)	207671	M	3/8" Bearing	207669
C	Long Bushing (2)	207670	N	3" Screw (2)	207672
D	Short Bushing (2)	204006	P	Quick-Attach Handle	304625
E	E-Ring	205012	Q	Handle Mount Rod	403889-BPL
F	Primary Shaft	303937	R	Lock Nut	205270
G	1/4-20 Nut (6)	205016	S	Nylon Lock Nut (2)	204694
H	Back Cover	207663	T	Handle Mount Plate	403890-BPL
J	Intermediate Gear Shaft	303938	U	Square Tube Bracket	207664
K	1/2" Bearing	205201	V	Round Tube Bracket	207665

To order these accessories or replacement parts contact your local D-L dealer or

Dutton-Lainson Company

www.dlco.com

Tel: 800-569-6577

Fax: 402-460-4612

email: DLsales@dutton-Lainson.com

COMPATIBILITY

This product is designed to be compatible with D-L brand jacks only. Other uses may void warranty. Contact your local dealer or D-L sales department for information on compatible jack models.