

INSTRUCTIONS - 6259 TIPPERLATCH

The Model 6259 Tipperlatch was designed for use on medium and light duty tilt-trailers such as boat, snowmobile, motorcycle, PWC and utility.

It is important that trailer design and cargo are balanced to tend to keep trailer bed level when it is loaded for travel.

⚠ WARNING: The tipperlatch should never be used on heavy-duty trailers such as car trailers where high upward forces are applied to the latching mechanism.

INSTALLATION INSTRUCTIONS

1. Bolt the tipperlatch to the trailer with as much contact between the latch bars and tilt bed as possible.
2. Use the largest possible bolts that will fit through the tipperlatch mounting holes.
3. When welding tipperlatch to the trailer frame or tongue care must be taken to get good penetration without undercutting either the tipperlatch or the surface the tipperlatch is being welded to.
4. If welded, weld the entire length of both sides of the body. These welds are critical and must be done by a competent welder.

⚠ CAUTION: Make certain if welded that there is no warpage or weld splatter that could interfere with proper operation.

ASSEMBLY INSTRUCTIONS

If not pre-assembled, place spring between the legs of the body, slide both latch bars through body and spring (larger cross first). Place latch plate over latch bars (short leg toward body) and locate lock lever over latch bars with bottom hole in-line with holes in the latch bars. Install bolt and nut as shown. The slide mechanism can be rotated to any of the (4) cross-slot positions.

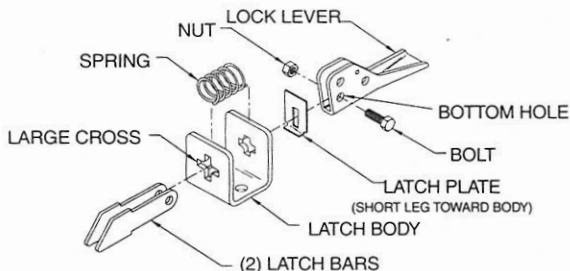

OPERATING INSTRUCTIONS

Lift lock lever to release the tilt-bed. After tilt-bed has raised past the height of the tipperlatch the lock lever can be lowered to the level position. The tipperlatch will then relatch the tilt-bed automatically as the tilt-bed is reset to the travel position.

⚠ WARNING: On each occasion the trailer is used, make certain the tipperlatch is securely latched and free from any damage. Failure to check the latch could result in trailer-cargo damage or serious personal injury.



A DEPENDABLE COMPANY - SINCE 1886
DUTTON-LAINSON COMPANY
Hastings, Nebraska 68902-0729 • 402-462-4141 • FAX 402-460-4612

MADE IN
U.S.A.